

# SITE PLAN

# THE ENCLAVE

MEDINA

**LENNAR®**

LENNAR CORPORATION  
935 East Wayzata Boulevard  
Wayzata, Minnesota 55391

Land Development Manager:  
Carole Toohey; 952-249-3012



**SATHRE-BERGQUIST, INC.**  
150 SOUTH BROADWAY WAYZATA, MN, 55391 (952) 476-6000

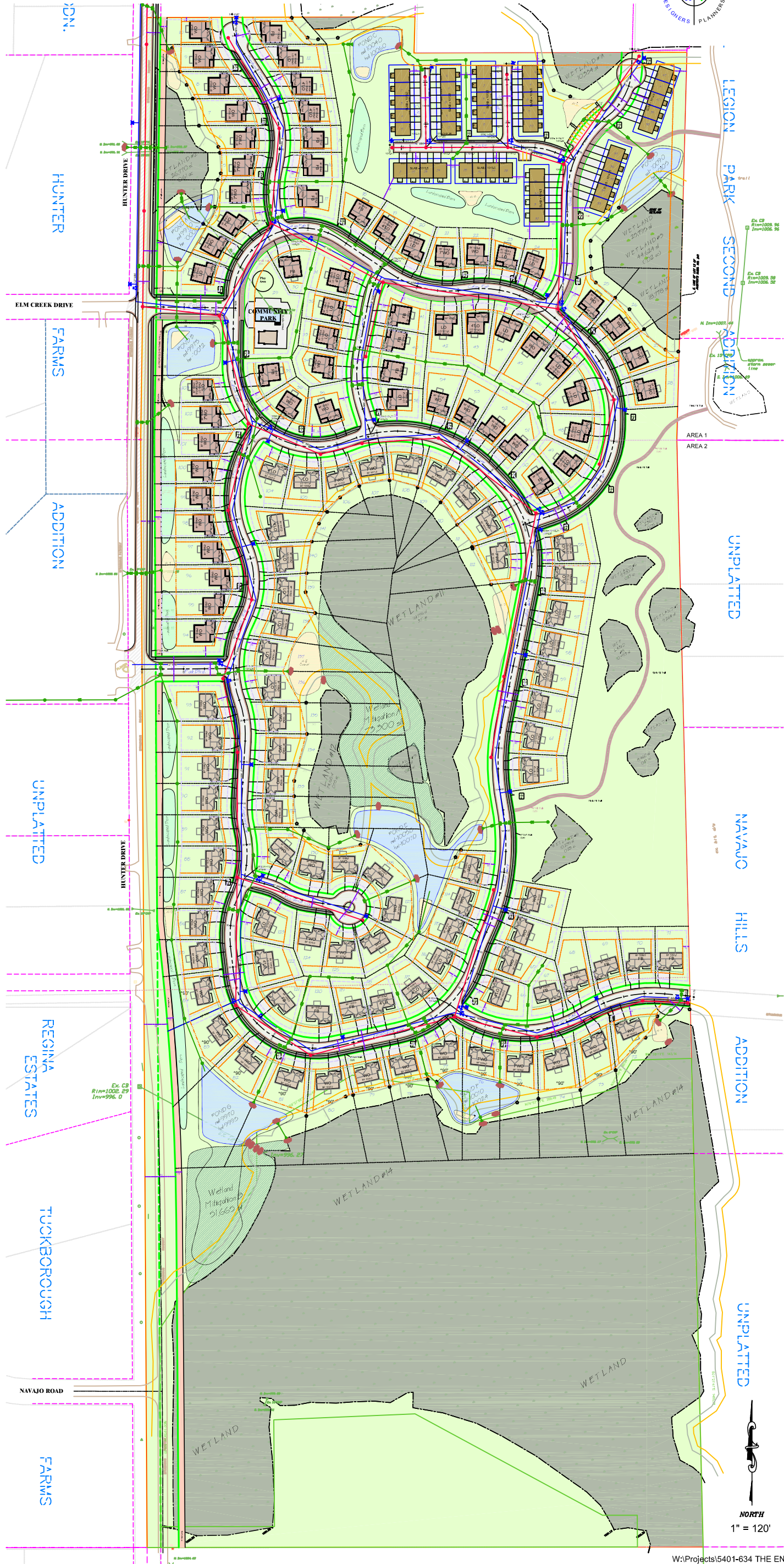

REVISIONS	BY

**Zoning:**  
Proposed Zoning - R1  
Min Width - 90 ft  
Min Area - 11,000 sf  
Fysb - 30 ft  
Sysb - 25 ft Total - 10 ft Min  
Rysb - 30 ft

50' Row - 28' B-B Streets

Proposed Zoning - R2  
Min Width - 60 ft  
Min Area - 8,000 sf  
Fysb - 30 ft  
Sysb - 15 ft Total - 5 ft Min  
Rysb - 25 ft

50' Row - 28' B-B Streets

Proposed Zoning - R3  
Min Area - 8,750 sf  
Fysb - 25 ft Private Street  
Fysb - 40 ft from Roadway  
Sysb - 30 ft between Bldgs  
Rysb - 20/40 ft  
24' B-B Private Streets  
50' Row - 28' B-B Streets

**CLIENT/DEVELOPER**

LENNAR CORPORATION  
935 East Wayzata Boulevard  
Wayzata, Minnesota 55391  
Attn: Carole Toohey  
T-952-249-3012

**LAND SURVEYOR/CIVIL ENGINEER**

SATHRE-BERGQUIST INC.  
150 S. Broadway Ave.  
Wayzata, MN 55391  
Attn: Bob Molstad - Engineer  
Attn: David Pemberton - Land Surveyor  
T-952-476-6000  
F-952-476-0104

SHEET INDEX TABLE	
SHEET	Description
SP	Preliminary Site Plan
PH	Preliminary Phasing Plan
AERIAL	Aerial Map (11x17 Only)
EX	Existing Conditions Plan
Alta	Alta/Boundary Survey
PP	Preliminary Plat
UP	Preliminary Utility Plan
GP	Preliminary Grading and Drainage Plan
EC	Preliminary Erosion Control Plan
TS	Tree Survey & Removal Plan
TR	Tree Replacement Plan
BF	Buffer Yard Plan

